

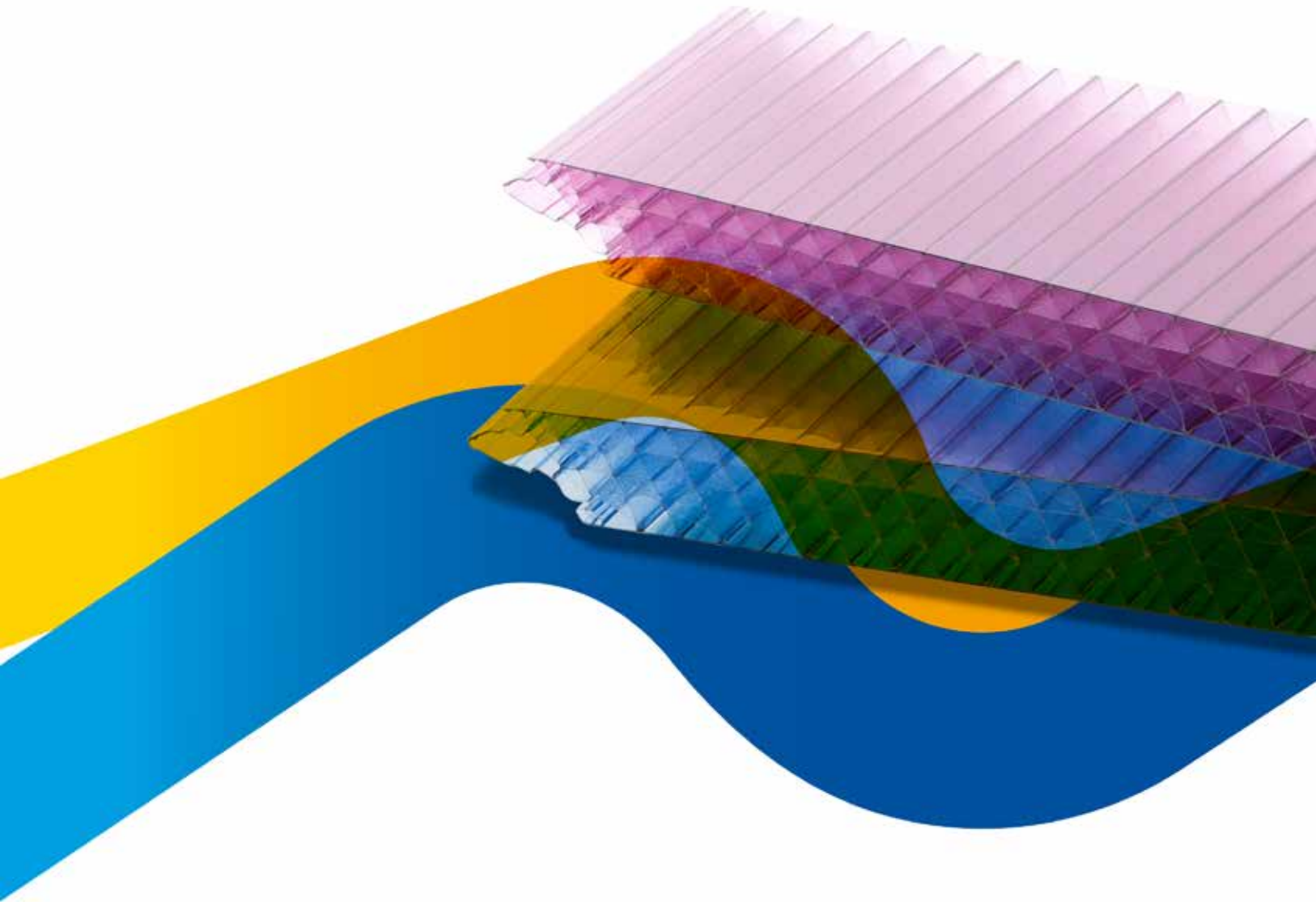

# EFFICIENCY+ CREATIVITY

LEXAN™ THERMOCLICK™ 40 AND 50 MM SHEET SYSTEMS



CHEMISTRY THAT MATTERS™

CLADDING AND FAÇADES HAVE AN IMPORTANT INFLUENCE ON THE CHARACTER OF A BUILDING. THE COST OF HEATING AND COOLING IS REACHING NEW LEVELS, CAUSING BUILDERS TO LOOK FOR NEW ALTERNATIVES TO INCREASE ENERGY EFFICIENCY.

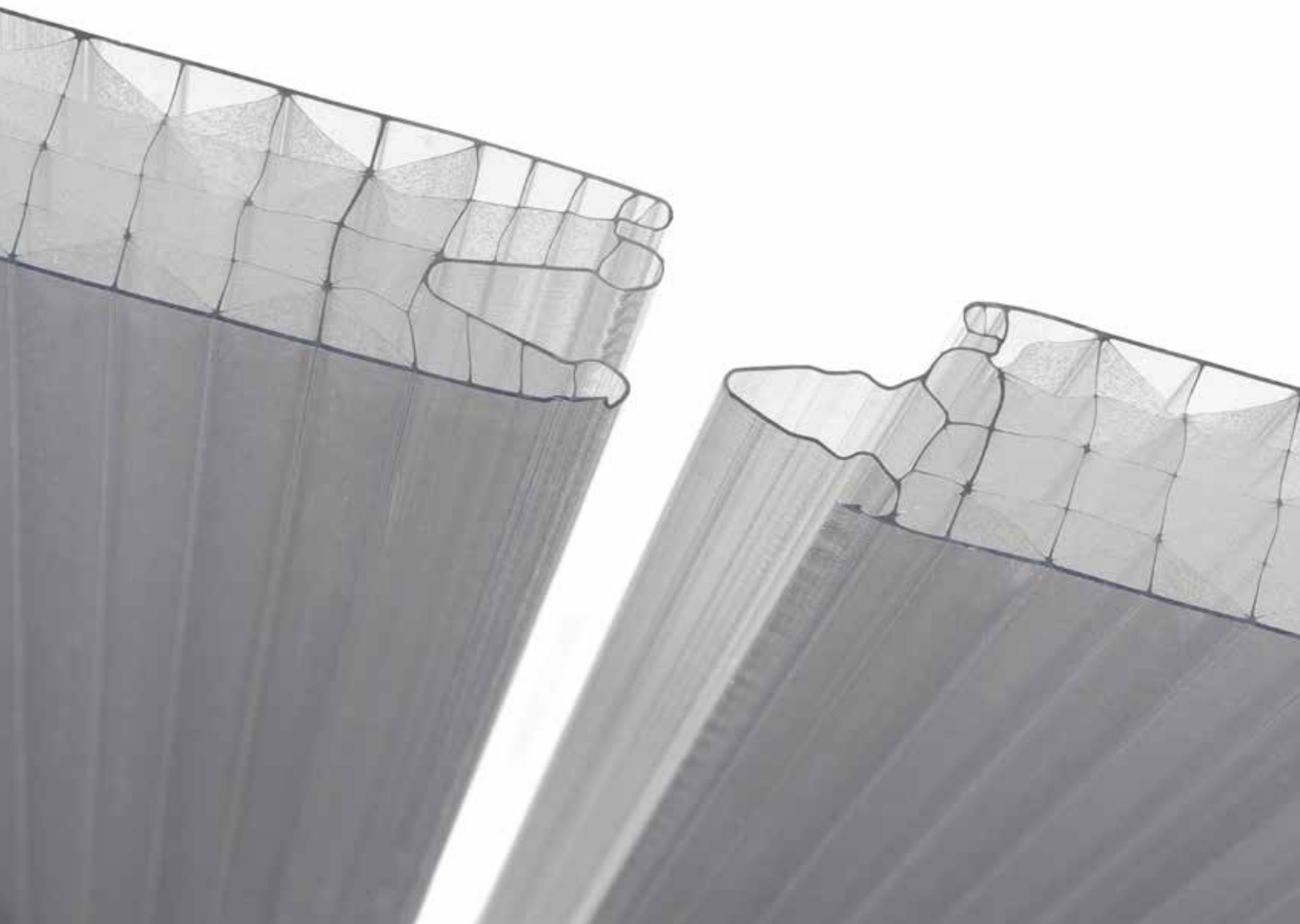

# INTRODUCTION

SABIC's Functional Forms business has developed two new LEXAN™ THERMOCLICK™ sheet systems in 40 and 50 mm thicknesses. These products are an excellent candidate for applications such as cladding and façades of residences, commercial buildings, shopping centers, office buildings, and factories. These new systems can not only help customers reduce heating and cooling costs, but also cut energy usage and CO<sub>2</sub> emissions to benefit the environment.



---

SABIC's high performance LEXAN THERMOCLICK sheet products can give the building and construction industry new ways to meet demands for increased energy efficiency in living and working environments. Also these new products allow designs that are visually striking and yet extremely practical.



---

Furthermore, the low maintenance end product can help to resist rust, rot or warp. Installation costs may be kept low as each product is designed using custom-made configurations for fast on-site assembly. A 10-year limited written warranty is given against loss of light transmission, discoloration and breakage.



---

Specifically for LEXAN THERMOCLICK 40 and 50 mm sheet, a new aluminum profile system with an especially designed cold bridge connection is developed. This new system prevents manifestation of condensation in the inside of the profile for partition walls, floor, ceiling and roofing.

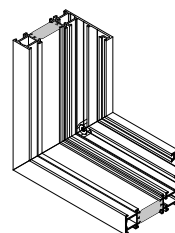
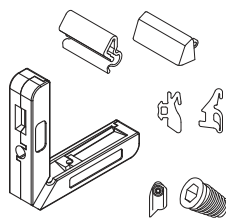
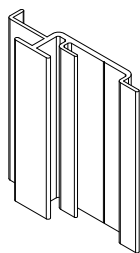
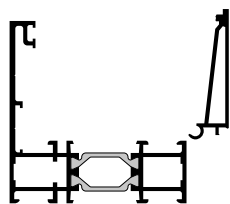
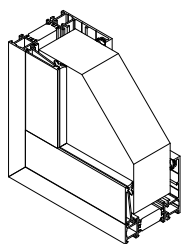
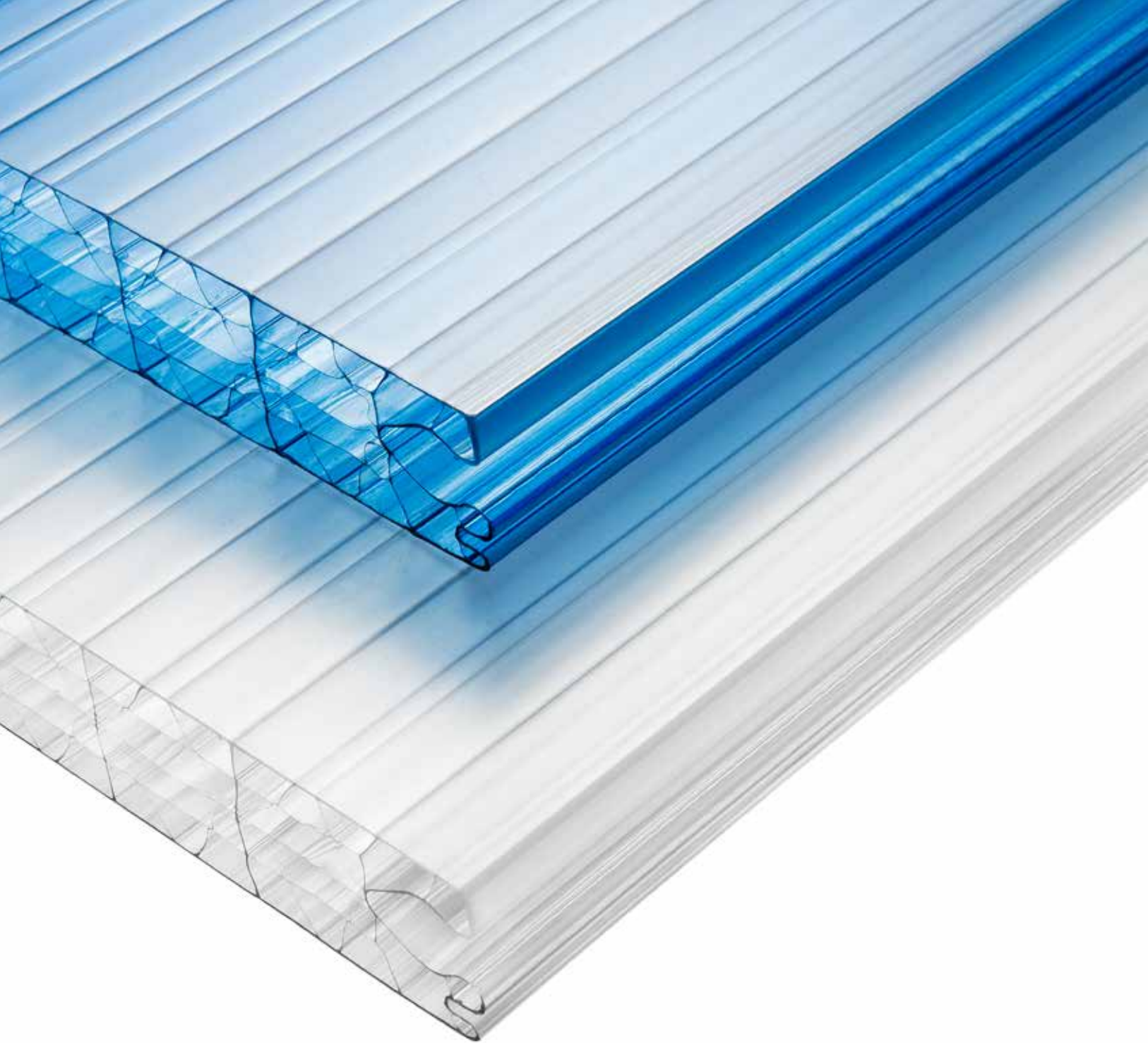

# IMPROVED U-VALUE

## LEXAN™ THERMOCLICK™ SHEET IN 40 MM

With specially designed tongue and groove connection, LEXAN THERMOCLICK sheet in 40 mm thickness [LTC404X4000] offers high impact resistance and very high thermal insulation leading to energy saving. This inter-connecting system including a groove for double-sided tie on the inside eliminates the need for vertical profiles, thereby saving costs and enhancing aesthetics. Also improved fix-key section connection can provide better loading performance compared to previous design.

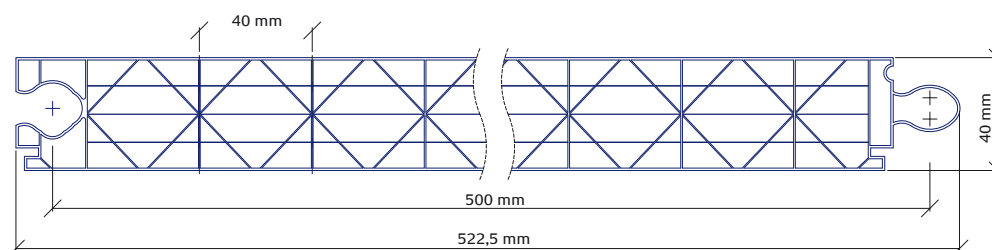

### LEXAN THERMOCLICK SHEET IN 40 MM [LTC404X4000] OFFERS

- Unique 5-wall with X-structure
- UV protected outer surface
- Good light transmission and light diffusion characteristics
- Improved-loading performance
- Excellent thermal insulation of 1.27 W/m<sup>2</sup> K
- High impact strength
- 10-year limited written warranty against long-term weathering conditions
- Fast and easy installation
- Wide range of colors and aesthetic effects

Property Profile	Value	Test Method
Panel width ctc	500 mm ±2.5 mm	
Standard length tolerance	-0 +15 mm	
Panel total thickness	40 mm ±0.8 mm	
Weight	4 kg/m <sup>2</sup> ±5%	
Hail impact	diam. 20 mm v ≥ 21m/sec	TNO Test
Temperature resist.	-40 up to +100°C	UL 746 BEN
U-Value	1.27 W/m <sup>2</sup> K	ISO 10077 (EN673)
Coeff. of linear thermal expansion	7 x 10 <sup>-5</sup> 1/°C	DIN 53752



# SUPERB INSULATION

## LEXAN™ THERMOCLICK™ SHEET IN 50 MM

The new 50 mm LEXAN THERMOCLICK sheet [LTC509X] is a unique, 9-wall product with a superb U-value of 1.0 W/ m<sup>2</sup>K leading to energy saving. This new product offers superior insulation properties vs. multi-pane glass, plus lightweight, extremely high impact resistance, stiffness and ultra violet (UV) protection. With specially designed V-joint connection profile, including a groove for double-sided tie on the inside, this inter-connecting system eliminates the need for vertical profiles, thereby saving costs and enhancing aesthetics.

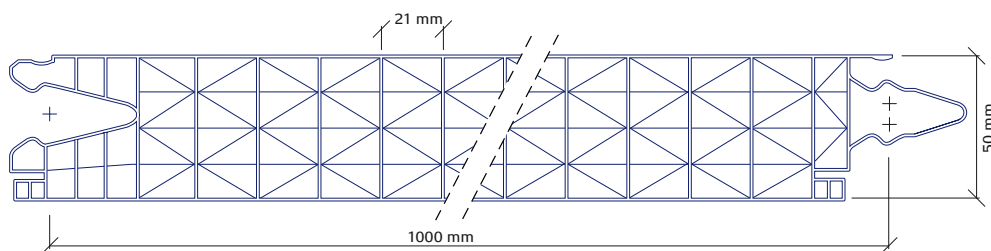

### LEXAN THERMOCLICK SHEET IN 50 MM (LTC509X) OFFERS

- Unique 9-wall with X-structure
- UV protected outer surface
- Good light transmission and light diffusion characteristics
- Extremely high stiffness
- Superb thermal insulation of 1.0W/m<sup>2</sup> K
- High impact strength
- 10-year limited written warranty against long-term weathering conditions
- Simple, easy and fast installation
- Wide range of colors and aesthetic effects

Property Profile	Value	Test Method
Panel width ctc	1000 mm ±2.5 mm	
Standard length tolerance	-0 +15 mm	
Panel total thickness	50 mm ±1 mm	
Weight	5.15 kg/m <sup>2</sup> ±5%	
Hail impact	diam. 20 mm v ≥ 21m/sec	TNO Test
Temperature resist.	-40 up to +100°C	UL 646 BEN
U-Value	1.00 W/m <sup>2</sup> K	
Coeff. of linear thermal expansion	7 x 10 <sup>-5</sup> 1/°C	DIN 53752

## CONTACT US

### Middle East and Africa

SABIC Global Headquarters  
PO Box 5101  
Riyadh 11422  
Saudi Arabia  
T +966 (0) 1 225 8000  
F +966 (0) 1 225 9000  
E [info@sabic.com](mailto:info@sabic.com)

### Americas

SABIC  
Functional Forms  
2500 CityWest Blvd.  
Suite 100  
Houston, Texas 77042  
USA  
T 1 800 323 3783 (toll-free)  
T 1 413 448 6655  
F (888) 443 2033  
E [spinside.sales@sabic.com](mailto:spinside.sales@sabic.com)

### Europe

SABIC  
Functional Forms  
Plasticslaan 1  
4612 PX Bergen op Zoom  
The Netherlands  
T +31 (0)164 293678  
F +31 (0)164 293272  
E [sfs.info@sabic.com](mailto:sfs.info@sabic.com)

### Asia Pacific

SABIC  
Functional Forms  
2550 Xiupu Road  
Pudong  
201319 Shanghai  
China  
T +86 21 3222 4500  
F +86 21 6289 8998  
E [sfs.info@sabic.com](mailto:sfs.info@sabic.com)



THE MATERIALS, PRODUCTS AND SERVICES OF SABIC, ITS SUBSIDIARIES AND AFFILIATES ("SELLER"), ARE SOLD SUBJECT TO SELLER'S STANDARD CONDITIONS OF SALE, WHICH CAN BE FOUND AT <http://www.sabic.com> AND ARE AVAILABLE UPON REQUEST. ALTHOUGH ANY INFORMATION OR RECOMMENDATION CONTAINED HEREIN IS GIVEN IN GOOD FAITH, SELLER MAKES NO WARRANTY OR GUARANTEE, EXPRESS OR IMPLIED, (i) THAT THE RESULTS DESCRIBED HEREIN WILL BE OBTAINED UNDER END-USE CONDITIONS, OR (ii) AS TO THE EFFECTIVENESS OR SAFETY OF ANY DESIGN INCORPORATING SELLER'S PRODUCTS, SERVICES OR RECOMMENDATIONS. EXCEPT AS PROVIDED IN SELLER'S STANDARD CONDITIONS OF SALE, SELLER SHALL NOT BE RESPONSIBLE FOR ANY LOSS RESULTING FROM ANY USE OF ITS PRODUCTS OR SERVICES DESCRIBED HEREIN. Each user is responsible for making its own determination as to the suitability of Seller's products, services or recommendations for the user's particular use through appropriate end-use testing and analysis. Nothing in any document or oral statement shall be deemed to alter or waive any provision of Seller's Standard Conditions of Sale or this Disclaimer, unless it is specifically agreed to in a writing signed by Seller. No statement by Seller concerning a possible use of any product, service or design is intended, or should be construed, to grant any license under any patent or other intellectual property right of Seller or as a recommendation for the use of such product, service or design in a manner that infringes any patent or other intellectual property right.

SABIC and brands marked with ™ are trademarks of SABIC or affiliates.  
© 2018 SABIC. All rights reserved.